

[BACK TO MAIN](#)



100 ton All-Terrain Crane Demag AC 205



MAXIM CRANE WORKS - (877) MAX-LIFT (629-5438)
www.maximcrane.com



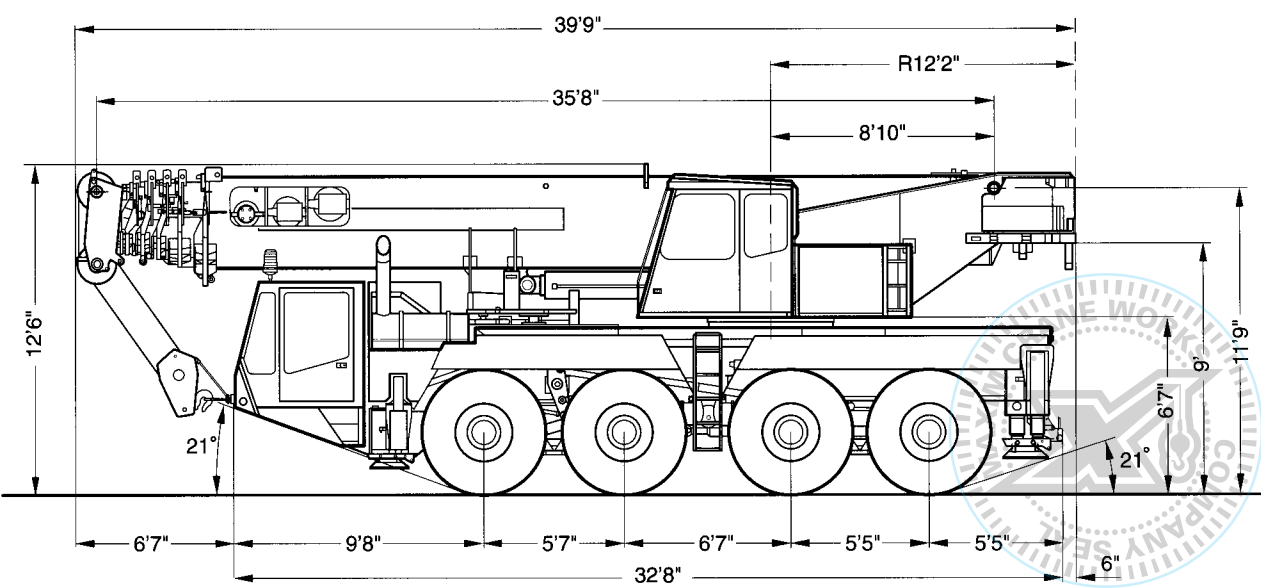

Dimensions

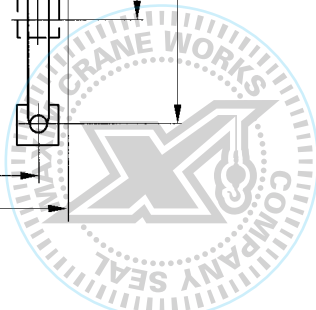
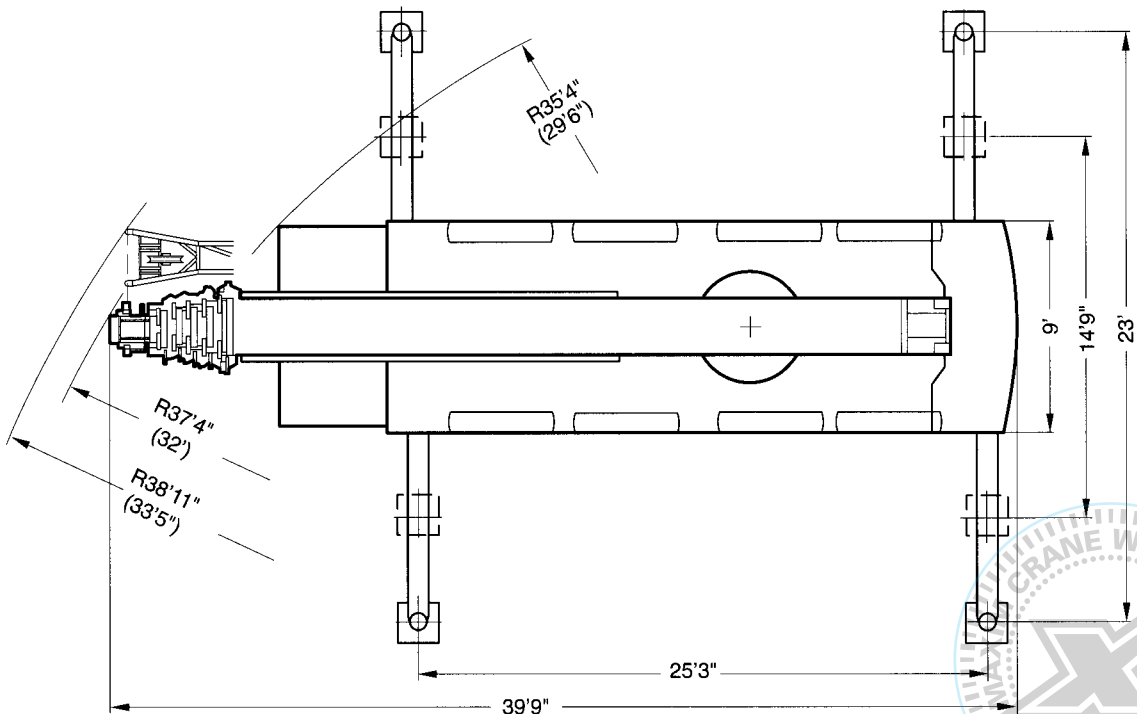
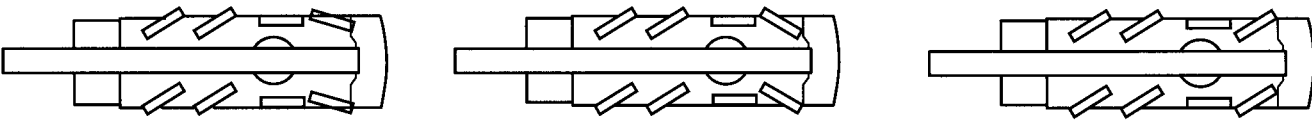

() with independent rear axle steering, 3rd axle raised

Specifications

Working speeds (infinitely variable)

Mechanisms	Normal speed	High speed	Max. permissible line pull ¹⁾	Length of hoist rope
Hoist I	174 ft/min	361 ft/min	13,200 lb	689 ft
Hoist II	174 ft/min	361 ft/min	13,200 lb	689 ft
Slewing				max. 2 rpm
Telescoping speed	35.8-164.0 ft: 110 s			
Boom elevation	-1,8° - +81,5°: 63 s			

Carrier performance

Travel speed	
Forward	0..45 mph
Reverse	0..7.5 mph
Gradeability in travel order	max. 50%
Ground clearance	1' 1"

Hook block/Single line hook

Type	Possible load ²⁾	Number of sheaves	Number of lines	Weight	"D"
100*)	176,000 lb	7	14	1,650 lb	6' 7"
80*)	145,200 lb	5	11	1,430 lb	6' 7"
50	92,400 lb	3	7	1,210 lb	5' 11"
20	39,600 lb	1	3	770 lb	5' 11"
6,3	13,200 lb	Single line hook		374 lb	5' 7"

*) heavy-lift attachment is required, without heavy-lift attachment: capacity 132,000 lb (10 lines)

¹⁾ varies depending on national regulations

²⁾ varies depending on line pull permissible under different national regulations

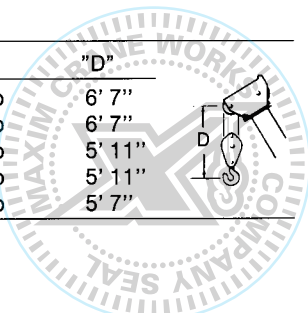

Working range main boom

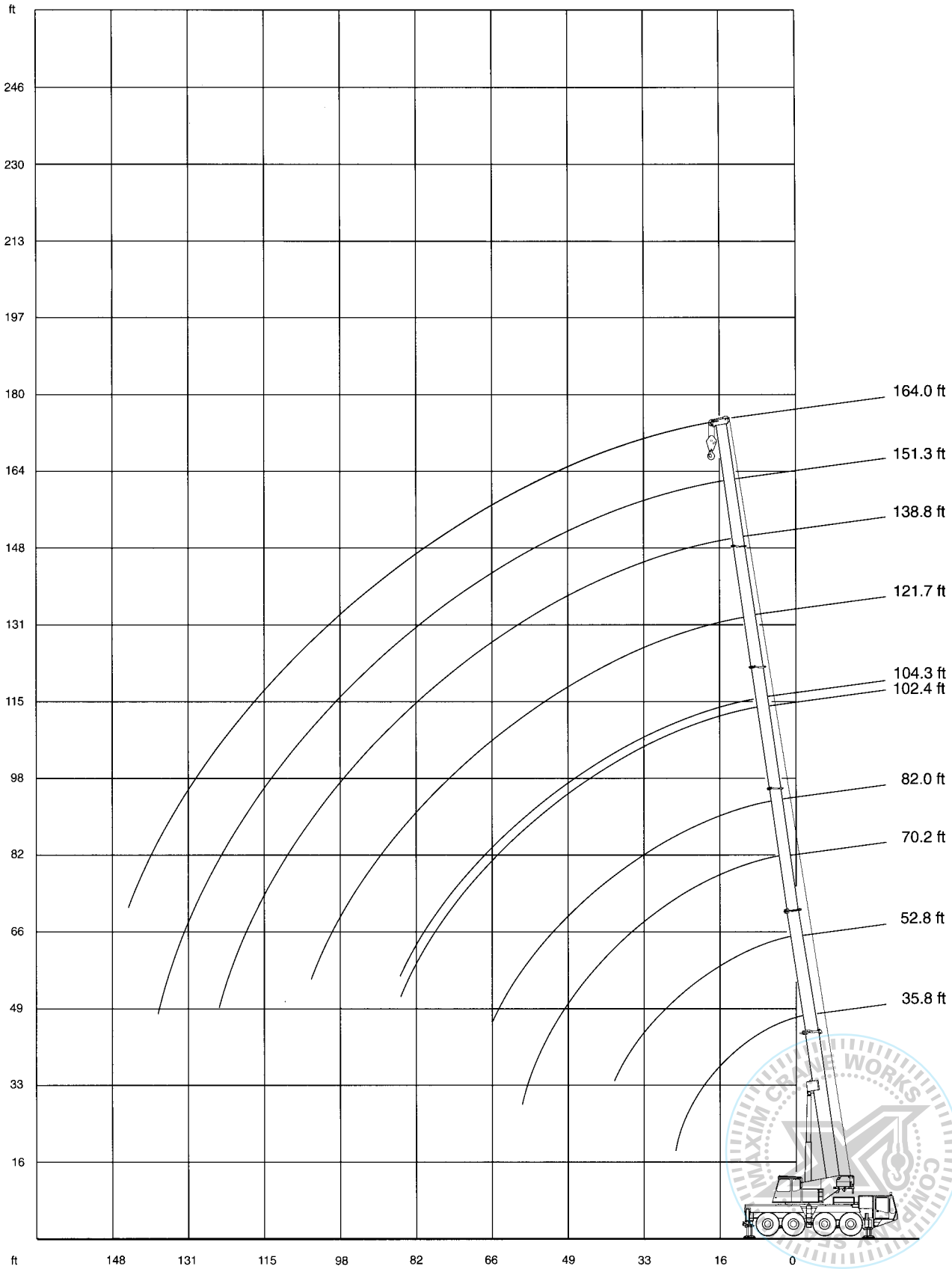

Lifting capacities main boom in 1,000 lb

39,700 lb

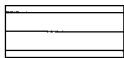

25'3" x 23' 360°

85%

Radius	Main boom (ft)														0° over rear	
	35.8 ft	52.8 ft	70.2 ft	70.5 ft	82.0 ft	82.0 ft	102.4 ft	104.3 ft	121.7 ft	122.1 ft	138.8 ft	139.4 ft	151.3 ft	164.0 ft	35.8 ft	52.8 ft
ft	1,000 lb														1,000 lb	
10	200.0*	-	-	-	-	-	-	-	-	-	-	-	-	-	-	-
10	168.5	-	-	-	-	-	-	-	-	-	-	-	-	-	-	-
11	160.7	121.2	-	-	-	-	-	-	-	-	-	-	-	-	-	-
13	145.5	121.2	97.3	41.2	-	-	-	-	-	-	-	-	-	-	44.8	44.3
15	132.4	120.4	91.2	41.2	72.7	38.8	-	-	-	-	-	-	-	-	40.0	39.6
16	126.6	116.9	87.5	41.2	72.7	38.8	41.2	36.5	-	-	-	-	-	-	37.9	37.4
19	106.9	104.3	78.8	41.2	70.6	38.8	41.2	35.1	36.5	26.6	-	-	-	-	32.6	32.0
23	85.1	84.5	69.3	41.2	63.2	38.8	41.2	32.3	35.6	26.6	26.6	19.4	-	-	26.8	26.4
26	70.0	73.2	63.5	41.2	57.5	38.8	41.2	30.1	34.2	26.6	26.6	19.4	19.4	-	23.4	22.7
29	-	64.1	58.2	41.2	52.2	38.8	41.2	28.3	33.0	26.6	26.6	19.4	19.4	14.5	-	19.1
33	-	53.1	50.9	40.8	46.0	38.7	38.8	25.6	31.2	26.1	26.6	19.4	19.3	14.5	-	15.5
39	-	40.0	37.8	37.4	37.5	36.0	34.0	22.6	28.1	23.5	26.2	19.4	18.9	14.5	-	11.4
46	-	-	28.1	33.4	28.1	31.6	29.2	20.0	24.6	20.6	23.7	17.6	18.2	14.3	-	-
52	-	-	22.5	27.8	22.3	26.6	25.8	18.0	22.2	18.4	21.1	16.2	17.2	13.9	-	-
59	-	-	17.4	22.5	17.2	21.6	20.7	16.3	19.6	16.3	18.5	14.5	16.3	13.0	-	-
65	-	-	-	-	14.0	18.2	17.5	15.1	18.0	14.5	16.7	13.1	14.9	12.2	-	-
72	-	-	-	-	-	-	14.4	13.9	15.2	12.8	15.0	11.9	13.6	11.2	-	-
79	-	-	-	-	-	-	11.8	12.5	12.7	11.6	12.4	10.7	12.2	10.1	-	-
85	-	-	-	-	-	-	10.0	11.7	10.8	10.6	10.4	9.9	10.8	9.3	-	-
92	-	-	-	-	-	-	-	-	9.2	9.6	8.7	9.2	9.2	8.3	-	-
98	-	-	-	-	-	-	-	-	7.8	8.4	7.3	8.4	7.8	7.7	-	-
105	-	-	-	-	-	-	-	-	6.3	7.2	6.1	7.2	6.6	6.6	-	-
111	-	-	-	-	-	-	-	-	-	-	5.1	6.2	5.6	5.6	-	-
118	-	-	-	-	-	-	-	-	-	-	4.2	5.3	4.6	4.6	-	-
124	-	-	-	-	-	-	-	-	-	-	3.2	4.5	3.6	3.6	-	-
131	-	-	-	-	-	-	-	-	-	-	-	-	2.8	2.8	-	-
138	-	-	-	-	-	-	-	-	-	-	-	-	2.1	2.1	-	-
144	-	-	-	-	-	-	-	-	-	-	-	-	-	1.5	-	-

Boom extension sequence %

Tele 1	0	0	67	0	80	36	67	0	67	40	90	67	90	100	0	0
Tele 2	0	67	67	34	100	36	67	67	67	74	90	67	90	100	0	67
Tele 3	0	0	0	34	0	36	42	67	67	74	74	90	90	100	0	0
Tele 4	0	0	0	34	0	36	42	67	67	74	74	90	90	100	0	0

*) over rear

Lifting capacities main boom in 1,000 lb

17,650 lb

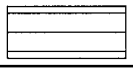

25'3" x 23' 360°

85%

Radius	Main boom (ft)														0° over rear	
	35.8 ft	52.8 ft	70.2 ft	70.5 ft	82.0 ft	82.0 ft	102.4 ft	104.3 ft	121.7 ft	122.1 ft	138.8 ft	139.4 ft	151.3 ft	164.0 ft	35.8 ft	52.8 ft
ft	1,000 lb														1,000 lb	
10	200.0*	-	-	-	-	-	-	-	-	-	-	-	-	-	-	-
10	168.4	-	-	-	-	-	-	-	-	-	-	-	-	-	-	-
11	160.1	121.2	-	-	-	-	-	-	-	-	-	-	-	-	-	-
13	144.6	121.2	97.3	41.2	-	-	-	-	-	-	-	-	-	-	43.6	43.2
15	126.3	120.0	91.2	41.2	72.7	38.8	-	-	-	-	-	-	-	-	36.8	36.2
16	117.2	114.9	87.5	41.2	72.7	38.8	41.2	36.5	-	-	-	-	-	-	33.3	32.7
19	96.1	95.6	78.8	41.2	70.6	38.8	41.2	35.1	36.5	26.6	-	-	-	-	25.5	24.8
23	75.6	74.7	69.2	41.2	63.1	38.8	41.2	32.3	35.6	26.6	26.6	19.4	-	-	18.4	17.8
26	59.7	58.8	55.9	41.2	55.3	38.8	41.2	30.1	34.2	26.6	26.6	19.4	19.4	-	15.0	14.3
29	-	47.9	45.2	41.2	45.2	38.8	41.2	28.3	33.0	26.6	26.6	19.4	19.4	14.5	-	11.7
33	-	37.5	35.1	40.7	35.1	38.5	38.7	25.6	31.2	26.1	26.6	19.4	19.3	14.5	-	8.9
39	-	27.3	25.0	31.4	24.8	30.0	29.2	22.6	28.1	23.5	26.2	19.4	18.9	14.5	-	6.1
46	-	-	17.3	23.5	17.1	21.9	21.3	20.0	22.4	20.6	22.2	17.6	18.2	14.3	-	-
52	-	-	12.9	18.9	12.7	17.5	16.9	18.0	17.7	18.4	17.5	16.2	17.2	13.9	-	-
59	-	-	9.0	14.8	8.8	13.6	12.6	15.4	13.9	14.8	13.6	14.5	14.1	13.0	-	-
65	-	-	-	-	6.4	10.8	9.9	13.0	11.0	12.1	10.8	12.1	11.5	11.4	-	-
72	-	-	-	-	-	-	7.5	10.4	8.8	9.5	8.2	9.5	9.1	9.1	-	-
79	-	-	-	-	-	-	5.6	8.7	6.7	7.6	6.5	7.6	6.9	6.9	-	-
85	-	-	-	-	-	-	4.4	7.1	5.3	6.2	5.1	6.2	5.5	5.5	-	-
92	-	-	-	-	-	-	-	4.1	4.8	3.5	4.8	4.1	4.1	-	-	-
98	-	-	-	-	-	-	-	3.1	4.0	2.7	4.0	3.1	3.1	-	-	-
105	-	-	-	-	-	-	-	2.2	2.8	1.7	2.8	2.2	2.2	-	-	-
111	-	-	-	-	-	-	-	-	-	-	2.2	-	-	-	-	-
118	-	-	-	-	-	-	-	-	-	-	1.5	-	-	-	-	-
Boom extension sequence %																
Tele 1	0	0	67	0	80	36	67	0	67	40	90	67	90	100	0	0
Tele 2	0	67	67	34	100	36	67	67	67	74	90	67	90	100	0	67
Tele 3	0	0	0	34	0	36	42	67	67	74	74	90	90	100	0	0
Tele 4	0	0	0	34	0	36	42	67	67	74	74	90	90	100	0	0

*) over rear

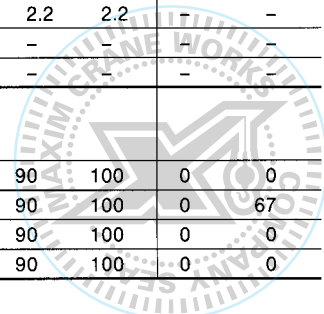

Lifting capacities main boom in 1,000 lb

11,050 lb

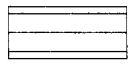

25' 3" x 23' 360°

85%

Radius	Main boom (ft)														0° over rear	
	35.8 ft	52.8 ft	70.2 ft	70.5 ft	82.0 ft	82.0 ft	102.4 ft	104.3 ft	121.7 ft	122.1 ft	138.8 ft	139.4 ft	151.3 ft	164.0 ft	35.8 ft	52.8 ft
ft	1,000 lb														1,000 lb	
10	168.4	-	-	-	-	-	-	-	-	-	-	-	-	-	-	-
11	160.1	121.2	-	-	-	-	-	-	-	-	-	-	-	-	-	-
13	143.6	121.2	97.3	41.2	-	-	-	-	-	-	-	-	-	-	39.7	39.0
15	122.0	119.4	91.2	41.2	72.7	38.8	-	-	-	-	-	-	-	-	31.6	31.0
16	113.1	111.9	87.5	41.2	72.7	38.8	41.2	36.5	-	-	-	-	-	-	28.4	27.9
19	92.6	92.1	78.8	41.2	70.6	38.8	41.2	35.1	36.5	26.6	-	-	-	-	21.5	20.9
23	67.5	66.6	63.3	41.2	63.1	38.8	41.2	32.3	35.6	26.6	26.6	19.4	-	-	15.1	14.7
26	53.0	52.1	49.4	41.2	49.2	38.8	41.2	30.1	34.2	26.6	26.6	19.4	19.4	-	12.1	11.7
29	-	42.2	39.7	41.2	39.5	38.8	41.2	28.3	33.0	26.6	26.6	19.4	19.4	14.5	-	9.2
33	-	32.7	30.1	37.1	30.1	35.8	34.5	25.6	31.1	26.1	26.6	19.4	19.3	14.5	-	6.9
39	-	23.2	20.8	27.4	20.8	26.1	25.0	22.6	26.3	23.5	25.6	19.4	18.9	14.5	-	4.1
46	-	-	14.0	20.0	13.8	18.9	17.8	20.0	19.1	20.0	18.9	17.6	18.2	14.3	-	-
52	-	-	9.8	16.1	9.6	14.6	13.9	16.8	15.1	15.7	14.6	15.5	15.2	13.9	-	-
59	-	-	6.6	12.3	6.2	11.2	10.1	13.0	11.4	12.1	10.8	12.3	11.7	11.7	-	-
65	-	-	-	-	4.1	8.6	7.7	10.8	9.0	9.9	8.6	9.9	9.2	9.2	-	-
72	-	-	-	-	-	-	5.5	8.4	6.8	7.5	6.4	7.5	6.8	6.8	-	-
79	-	-	-	-	-	-	3.9	6.7	5.0	5.6	4.5	5.6	5.2	5.2	-	-
85	-	-	-	-	-	-	2.7	5.5	3.5	4.6	3.3	4.6	4.0	4.0	-	-
92	-	-	-	-	-	-	-	2.6	3.2	2.1	3.2	2.6	2.6	2.6	-	-
98	-	-	-	-	-	-	-	1.8	2.4	-	2.4	1.8	1.8	1.8	-	-
105	-	-	-	-	-	-	-	-	1.7	-	1.7	-	-	-	-	-

Boom extension sequence %

Tele 1	0	0	67	0	80	36	67	0	67	40	90	67	90	100	0	0
Tele 2	0	67	67	34	100	36	67	67	67	74	90	67	90	100	0	67
Tele 3	0	0	0	34	0	36	42	67	67	74	74	90	90	100	0	0
Tele 4	0	0	0	34	0	36	42	67	67	74	74	90	90	100	0	0

*) over rear

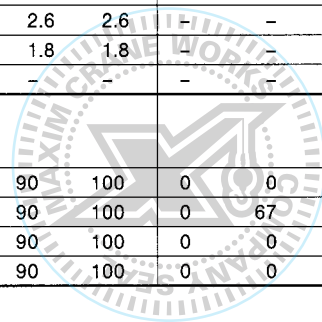

Lifting capacities main boom in 1,000 lb

39,700 lb

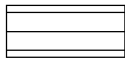

25'3" x 14'9" 360°

85%

Radius ft	Main boom (ft)													
	35.8 ft	52.8 ft	70.2 ft	70.5 ft	82.0 ft	82.0 ft	102.4 ft	104.3 ft	121.7 ft	122.1 ft	138.8 ft	139.4 ft	151.3 ft	164.0 ft
	1,000 lb													
10	148.9	-	-	-	-	-	-	-	-	-	-	-	-	-
11	139.9	121.2	-	-	-	-	-	-	-	-	-	-	-	-
13	124.1	121.2	97.3	41.2	-	-	-	-	-	-	-	-	-	-
15	110.6	109.7	91.2	41.2	72.7	38.8	-	-	-	-	-	-	-	-
16	100.4	99.4	87.5	41.2	72.7	38.8	41.2	36.5	-	-	-	-	-	-
19	74.0	73.2	69.4	41.2	66.4	38.8	41.2	35.1	36.5	26.6	-	-	-	-
23	51.7	51.0	48.8	41.2	48.6	38.8	41.2	32.3	35.6	26.6	26.6	19.4	-	-
26	42.2	41.5	39.3	41.2	39.3	38.8	41.2	30.1	34.2	26.6	26.6	19.4	19.4	-
29	-	34.4	32.4	37.7	32.4	36.3	35.8	28.3	33.0	26.6	26.6	19.4	19.4	14.5
33	-	27.7	25.7	31.0	25.5	29.7	29.0	25.6	30.4	26.1	26.5	19.4	19.3	14.5
39	-	20.7	18.9	24.0	18.9	22.7	22.0	22.6	22.9	23.5	22.5	19.4	18.9	14.5
46	-	-	13.6	18.2	13.1	17.1	16.4	18.9	17.3	18.2	17.1	17.6	17.6	14.3
52	-	-	10.4	14.8	10.1	13.9	13.0	15.4	14.1	14.6	13.9	14.7	14.3	13.9
59	-	-	7.5	11.9	7.2	10.8	10.1	12.3	11.2	11.7	10.8	11.7	11.2	11.2
65	-	-	-	-	5.2	9.0	8.1	10.5	9.2	9.6	9.0	9.8	9.2	9.4
72	-	-	-	-	-	-	6.6	8.4	7.3	7.7	7.1	7.9	7.3	7.3
79	-	-	-	-	-	-	5.0	7.2	5.6	6.5	5.4	6.5	6.1	6.1
85	-	-	-	-	-	-	4.0	6.2	4.8	5.3	4.4	5.3	4.9	4.9
92	-	-	-	-	-	-	-	-	3.5	4.3	3.2	4.3	3.5	3.5
98	-	-	-	-	-	-	-	-	2.7	3.3	2.2	3.3	2.7	2.7
105	-	-	-	-	-	-	-	-	-	2.6	-	2.4	-	-
106	-	-	-	-	-	-	-	-	-	-	-	1.8	-	-

Boom extension sequence %

Tele 1	0	0	67	0	80	36	67	0	67	40	90	67	90	100
Tele 2	0	67	67	34	100	36	67	67	67	74	90	67	90	100
Tele 3	0	0	0	34	0	36	42	67	67	74	74	90	90	100
Tele 4	0	0	0	34	0	36	42	67	67	74	74	90	90	100

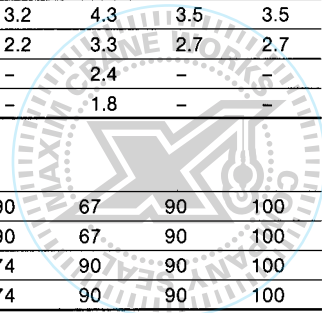

Lifting capacities main boom in 1,000 lb

17,650 lb

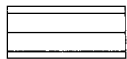

25'3" x 14'9" 360°

85 %

Radius ft	Main boom (ft)													
	35.8 ft	52.8 ft	70.2 ft	70.5 ft	82.0 ft	82.0 ft	102.4 ft	104.3 ft	121.7 ft	122.1 ft	138.8 ft	139.4 ft	151.3 ft	164.0 ft
	1,000 lb													
10	144.1	-	-	-	-	-	-	-	-	-	-	-	-	-
11	135.7	125.2	-	-	-	-	-	-	-	-	-	-	-	-
13	110.4	108.6	98.4	41.2	-	-	-	-	-	-	-	-	-	-
15	80.0	79.1	75.7	41.2	71.2	38.8	-	-	-	-	-	-	-	-
16	69.8	69.1	65.9	41.2	64.6	38.8	41.2	36.5	-	-	-	-	-	-
19	50.0	49.3	46.7	41.2	46.6	38.8	41.2	35.1	36.5	26.6	-	-	-	-
23	34.3	33.6	31.2	38.0	31.2	36.5	35.6	32.3	35.6	26.6	26.6	19.4	-	-
26	27.4	26.8	24.5	30.5	24.5	29.4	28.7	30.1	29.8	26.6	26.6	19.4	19.4	-
29	-	21.7	19.7	25.5	19.7	24.4	23.4	26.4	24.6	25.0	24.0	19.4	19.4	14.5
33	-	16.8	14.8	20.5	14.8	19.2	18.5	21.2	19.4	20.5	19.2	19.2	19.2	14.5
39	-	11.9	10.2	15.1	10.0	14.2	13.3	15.7	14.4	15.1	14.2	15.0	14.6	14.3
46	-	-	6.5	11.2	6.3	10.1	9.4	11.8	10.3	11.2	10.1	11.2	10.3	10.3
52	-	-	3.7	8.5	3.5	7.6	7.0	9.4	7.9	8.5	7.6	8.5	8.1	8.1
59	-	-	1.5	6.6	1.3	5.5	4.8	7.2	5.7	6.4	5.5	6.6	5.7	5.7
65	-	-	-	-	-	4.1	3.2	5.6	4.3	4.9	4.1	5.0	4.5	4.3
72	-	-	-	-	-	-	-	4.4	2.6	3.3	2.4	3.5	2.9	2.6
79	-	-	-	-	-	-	-	3.0	-	2.1	-	2.1	-	-
85	-	-	-	-	-	-	-	2.2	-	-	-	-	-	-

Boom extension sequence %

Tele 1	0	0	67	0	80	36	67	0	67	40	90	67	90	100
Tele 2	0	67	67	34	100	36	67	67	67	74	90	67	90	100
Tele 3	0	0	0	34	0	36	42	67	67	74	74	90	90	100
Tele 4	0	0	0	34	0	36	42	67	67	74	74	90	90	100

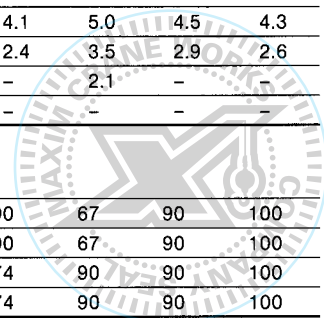

Lifting capacities main boom in 1,000 lb

11,050 lb

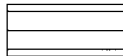

25'3" x 14'9" 360°

85%

Main boom (ft)

Radius ft	35.8 ft	52.8 ft	70.2 ft	70.5 ft	82.0 ft	82.0 ft	102.4 ft	104.3 ft	121.7 ft	122.1 ft	138.8 ft	139.4 ft	151.3 ft	164.0 ft
	1,000 lb													
10	143.0	-	-	-	-	-	-	-	-	-	-	-	-	-
11	134.7	129.3	-	-	-	-	-	-	-	-	-	-	-	-
13	97.3	95.7	90.9	41.2	-	41.2	-	-	-	-	-	-	-	-
15	69.5	68.4	65.2	41.2	64.9	38.8	-	-	-	-	-	-	-	-
16	60.6	59.5	56.6	41.2	56.3	38.8	41.2	36.5	-	-	-	-	-	-
19	42.9	42.2	39.7	41.2	39.4	38.8	41.0	35.1	37.2	26.6	-	-	-	-
23	29.0	28.3	26.1	32.9	26.1	31.4	30.5	32.3	31.8	26.6	26.6	19.4	-	-
26	22.9	22.3	20.3	26.5	20.1	25.0	24.3	27.3	25.4	26.0	24.8	19.4	19.4	-
29	-	17.9	15.9	21.9	15.9	20.4	19.7	22.8	20.8	21.7	20.6	19.4	19.4	14.5
33	-	13.7	11.7	17.2	11.7	16.1	15.2	18.1	16.3	17.2	16.1	17.2	16.6	14.4
39	-	9.5	7.5	12.6	7.5	11.5	10.6	13.3	11.9	12.6	11.7	12.6	11.9	11.8
46	-	-	3.9	9.0	3.4	7.9	7.2	9.6	8.1	9.0	7.9	9.0	8.3	8.1
52	-	-	-	7.0	-	5.6	5.2	7.4	5.9	6.7	5.6	6.7	6.3	5.7
59	-	-	-	4.8	-	3.9	2.8	5.5	4.2	4.8	3.5	4.8	4.2	3.9
65	-	-	-	-	-	2.3	-	4.3	2.5	3.4	2.3	3.4	2.7	2.3
72	-	-	-	-	-	-	-	2.9	-	2.0	-	2.0	-	-
79	-	-	-	-	-	-	-	1.9	-	-	-	-	-	-

Boom extension sequence %

Tele 1	0	0	67	0	80	36	67	0	67	40	90	67	90	100
Tele 2	0	67	67	34	100	36	67	67	67	74	90	67	90	100
Tele 3	0	0	0	34	0	36	42	67	67	74	74	90	90	100
Tele 4	0	0	0	34	0	36	42	67	67	74	74	90	90	100

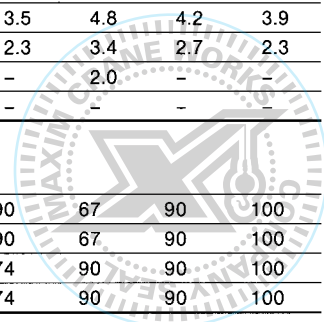

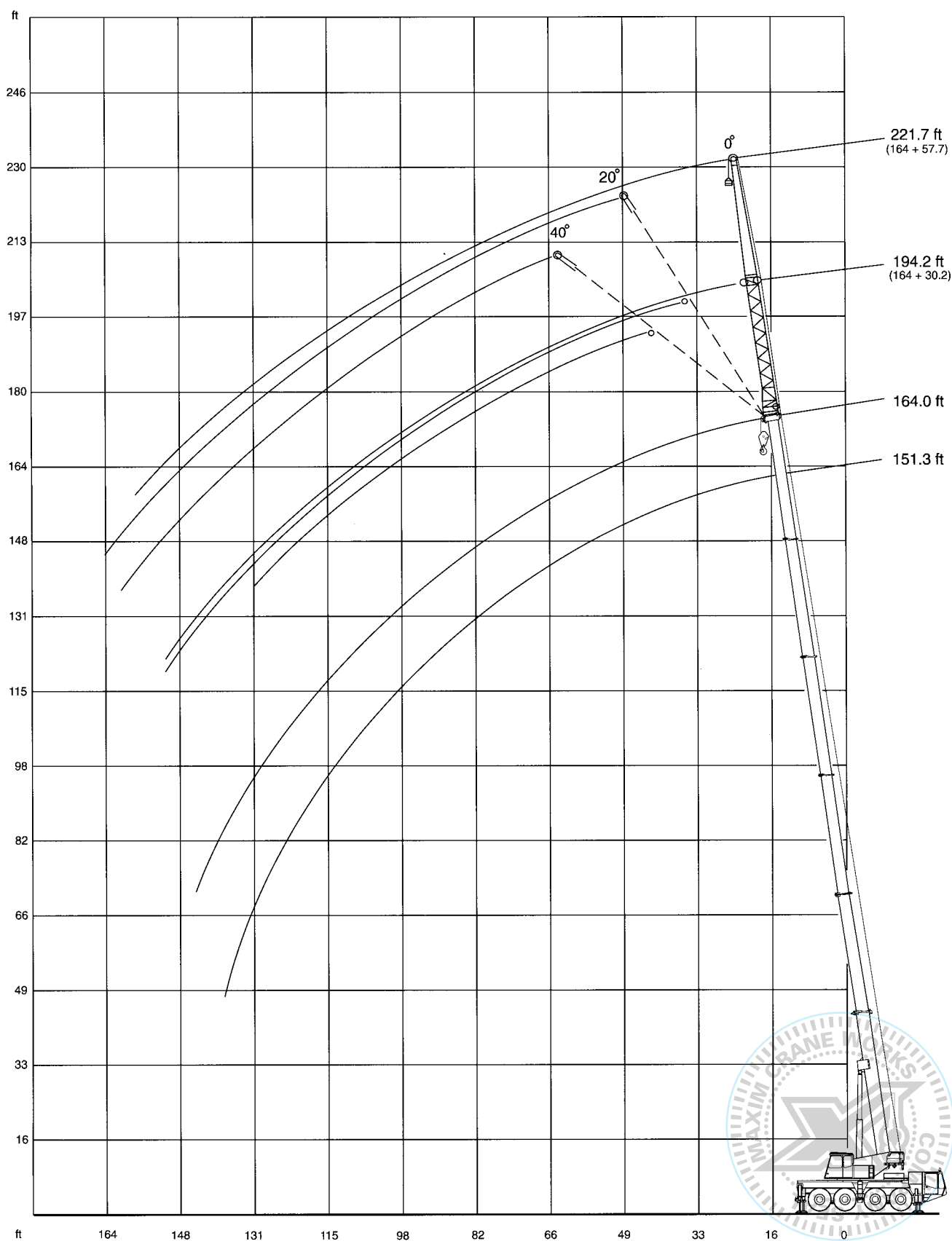

Working range main boom extension



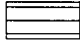

Lifting capacities main boom extension in 1,000 lb

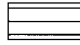

Main boom: 164.0 ft

39,700 lb   **25'3"x23' 360° 85%**

Radius	Extension					
	30.2 ft			57.7 ft		
	0°	20°	40°	0°	20°	40°
ft	1,000 lb					
39	6.8	-	-	-	-	-
46	6.8	6.8	-	2.4	-	-
52	6.8	6.8	6.4	2.4	-	-
59	6.8	6.6	6.1	2.4	-	-
65	6.6	6.2	5.7	2.4	2.4	-
72	6.1	5.7	5.5	2.4	2.4	-
79	5.7	5.4	5.0	2.4	2.4	2.4
85	5.3	5.0	4.8	2.4	2.4	2.4
92	5.0	4.8	4.6	2.4	2.4	2.4
98	4.8	4.6	4.4	2.2	2.4	2.4
105	4.6	4.4	4.1	2.2	2.4	2.4
111	4.4	4.2	3.9	2.0	2.2	2.4
118	4.1	3.9	3.5	1.9	2.2	2.2
124	3.9	3.5	3.5	1.9	2.0	2.2
131	3.3	3.5	3.3	1.9	1.9	1.9
138	2.6	2.8	-	1.7	1.9	1.9
144	2.0	2.4	-	1.7	1.9	1.9
151	1.5	1.7	-	1.7	1.7	1.7
157	-	-	-	1.5	1.7	1.7
164	-	-	-	-	1.5	-

17,650 lb   **25'3"x23' 360° 85%**

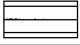
Radius	Extension					
	30.2 ft			57.7 ft		
	0°	20°	40°	0°	20°	40°
ft	1,000 lb					
39	6.8	-	-	-	-	-
46	6.8	6.8	-	2.4	-	-
52	6.8	6.8	6.4	2.4	-	-
59	6.8	6.6	6.1	2.4	-	-
65	6.6	6.2	5.7	2.4	2.4	-
72	6.1	5.7	5.5	2.4	2.4	-
79	5.7	5.4	5.0	2.4	2.4	2.4
85	5.3	5.0	4.8	2.4	2.4	2.4
92	4.6	4.8	4.6	2.4	2.4	2.4
98	3.5	4.4	4.4	2.2	2.4	2.4
105	2.6	3.3	3.9	2.2	2.4	2.4
111	1.8	2.4	2.9	2.0	2.2	2.4
118	-	1.7	2.2	1.7	2.2	2.2
124	-	-	-	-	2.0	2.2
131	-	-	-	-	1.5	1.9
138	-	-	-	-	-	1.5

11,050 lb   **25'3"x23' 360° 85%**

Radius	Extension					
	30.2 ft			57.7 ft		
	0°	20°	40°	0°	20°	40°
ft	1,000 lb					
39	6.8	-	-	-	-	-
46	6.8	6.8	-	2.4	-	-
52	6.8	6.8	6.4	2.4	-	-
59	6.8	6.6	6.1	2.4	-	-
65	6.6	6.2	5.7	2.4	2.4	-
72	6.1	5.7	5.5	2.4	2.4	-
79	5.4	5.4	5.0	2.4	2.4	2.4
85	4.2	5.0	4.8	2.4	2.4	2.4
92	3.0	4.1	4.6	2.4	2.4	2.4
98	2.2	2.9	3.5	2.2	2.4	2.4
105	-	2.2	2.6	1.7	2.4	2.4
111	-	-	1.8	-	2.2	2.4
118	-	-	-	-	1.5	2.2
124	-	-	-	-	-	2.0



Lifting capacities main boom extension in 1,000 lb

Main boom: 151.3 ft

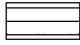
39,700 lb  **25'3"x23' 360° 85%**

Radius	Extension					
	30.2 ft			57.7 ft		
	0°	20°	40°	0°	20°	40°
ft	1,000 lb					
33	9.2	-	-	-	-	-
39	9.2	-	-	3.5	-	-
46	9.2	8.1	-	3.5	-	-
52	9.2	8.1	7.2	3.5	-	-
59	9.0	7.7	7.0	3.5	3.3	-
65	8.8	7.5	6.8	3.5	3.3	-
72	8.1	7.2	6.6	3.3	3.3	-
79	7.6	6.8	6.3	3.2	3.3	2.8
85	7.2	6.6	6.1	3.0	3.3	2.6
92	7.0	6.1	5.7	3.0	3.0	2.6
98	6.6	5.5	5.5	3.0	3.0	2.6
105	6.1	5.2	5.2	2.8	2.8	2.6
111	5.7	5.0	4.8	2.8	2.8	2.6
118	5.0	4.8	4.6	2.6	2.8	2.4
124	4.2	4.6	4.4	2.6	2.6	2.4
131	3.3	3.9	4.1	2.6	2.6	2.4
138	2.6	3.0	-	2.4	2.6	2.4
144	2.2	2.4	-	2.4	2.4	2.4
151	1.7	1.9	-	2.1	2.4	2.4
157	-	-	-	1.7	2.2	2.4
164	-	-	-	-	1.7	-

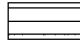
17,650 lb  **25'3"x23' 360° 85%**

Radius	Extension					
	30.2 ft			57.7 ft		
	0°	20°	40°	0°	20°	40°
ft	1,000 lb					
33	9.2	-	-	-	-	-
39	9.2	-	-	3.5	-	-
46	9.2	8.1	-	3.5	-	-
52	9.2	8.1	7.2	3.5	-	-
59	9.0	7.7	7.0	3.5	3.3	-
65	8.8	7.5	6.8	3.5	3.3	-
72	8.1	7.2	6.6	3.3	3.3	-
79	7.6	6.8	6.3	3.2	3.3	2.8
85	6.2	6.6	6.1	3.0	3.3	2.6
92	4.8	5.4	5.7	3.0	3.0	2.6
98	3.6	4.4	5.1	3.0	3.0	2.6
105	2.6	3.3	3.9	2.8	2.8	2.6
111	2.0	2.4	2.9	2.4	2.8	2.6
118	-	1.7	2.2	1.7	2.8	2.4
124	-	-	1.6	-	2.2	2.4
131	-	-	-	-	1.5	2.2
138	-	-	-	-	-	1.5

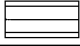

11,050 lb  **25'3"x23' 360° 85%**

Radius	Extension					
	30.2 ft			57.7 ft		
	0°	20°	40°	0°	20°	40°
ft	1,000 lb					
33	9.2	-	-	-	-	-
39	9.2	-	-	3.5	-	-
46	9.2	8.1	-	3.5	-	-
52	9.2	8.1	7.2	3.5	-	-
59	9.0	7.7	7.0	3.5	3.3	-
65	8.8	7.5	6.8	3.5	3.3	-
72	7.5	7.2	6.6	3.3	3.3	-
79	5.6	6.7	6.3	3.2	3.3	2.8
85	4.4	5.5	6.1	3.0	3.3	2.6
92	3.2	4.1	4.8	3.0	3.0	2.6
98	2.2	3.1	3.6	2.8	3.0	2.6
105	1.5	2.2	2.6	2.2	2.8	2.6
111	-	1.5	1.8	1.5	2.6	2.6
118	-	-	-	-	1.9	2.4
124	-	-	-	-	-	2.0



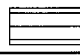

Lifting capacities main boom extension in 1,000 lb

Main boom: 151.3 ft



39,700 lb   **25'3"x14'9" 360° 85%**

Radius	Extension					
	30.2 ft			57.7 ft		
	0°	20°	40°	0°	20°	40°
ft	1,000 lb					
33	9.2	-	-	-	-	-
39	9.2	-	-	3.5	-	-
46	9.2	8.1	-	3.5	-	-
52	9.2	8.1	7.2	3.5	-	-
59	9.0	7.7	7.0	3.5	3.3	-
65	8.8	7.5	6.8	3.5	3.3	-
72	7.7	7.2	6.6	3.3	3.3	-
79	6.3	6.8	6.3	3.2	3.3	2.8
85	5.3	6.2	6.1	3.0	3.3	2.6
92	4.1	4.8	5.2	3.0	3.0	2.6
98	3.1	4.0	4.4	3.0	3.0	2.6
105	2.2	2.8	3.3	2.8	2.8	2.6
111	1.5	2.2	2.4	2.2	2.8	2.6
118	-	1.5	1.7	1.5	2.4	2.4
124	-	-	-	-	2.0	2.4
131	-	-	-	-	-	2.0

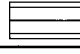

17,650 lb   **25'3"x14'9" 360° 85%**

Radius	Extension					
	30.2 ft			57.7 ft		
	0°	20°	40°	0°	20°	40°
ft	1,000 lb					
33	9.2	-	-	-	-	-
39	9.2	-	-	3.5	-	-
46	9.2	8.1	-	3.5	-	-
52	8.4	8.1	7.2	3.5	-	-
59	6.4	7.5	7.0	3.5	3.3	-
65	4.7	5.8	6.8	3.5	3.3	-
72	3.1	4.4	5.3	3.3	3.3	-
79	1.9	3.0	3.9	2.1	3.2	2.8
85	-	2.0	2.7	1.5	3.0	2.6
92	-	-	1.7	-	2.1	2.6
98	-	-	-	-	1.5	2.6
105	-	-	-	-	-	1.7

Main boom: 164.0 ft

39,750 lb   **25'3"x14'9" 360° 85%**

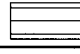
Radius	Extension					
	30.2 ft			57.7 ft		
	0°	20°	40°	0°	20°	40°
ft	1,000 lb					
39	6.8	-	-	-	-	-
46	6.8	6.8	-	2.4	-	-
52	6.8	6.8	6.4	2.4	-	-
59	6.8	6.6	6.1	2.4	-	-
65	6.6	6.2	5.7	2.4	2.4	-
72	6.1	5.7	5.5	2.4	2.4	-
79	5.7	5.4	5.0	2.4	2.4	2.4
85	5.1	5.0	4.8	2.4	2.4	2.4
92	4.1	4.8	4.6	2.4	2.4	2.4
98	3.1	4.0	4.4	2.2	2.4	2.4
105	2.2	2.8	3.3	2.2	2.4	2.4
111	1.5	2.2	2.4	2.0	2.2	2.4
118	-	1.5	1.7	-	2.2	2.2
124	-	-	-	-	1.8	2.2
131	-	-	-	-	-	1.9

17,650 lb   **25'3"x14'9" 360° 85%**

Radius	Extension					
	30.2 ft			57.7 ft		
	0°	20°	40°	0°	20°	40°
ft	1,000 lb					
39	6.8	-	-	-	-	-
46	6.8	6.8	-	2.4	-	-
52	6.8	6.8	6.4	2.4	-	-
59	5.7	6.6	6.1	2.4	-	-
65	4.3	5.6	5.7	2.4	2.4	-
72	2.6	4.0	5.0	2.4	2.4	-
79	1.7	2.6	3.4	1.9	2.4	2.4
85	-	1.8	2.4	-	2.4	2.4
92	-	-	1.5	-	1.9	2.4
98	-	-	-	-	-	2.4
105	-	-	-	-	-	1.5

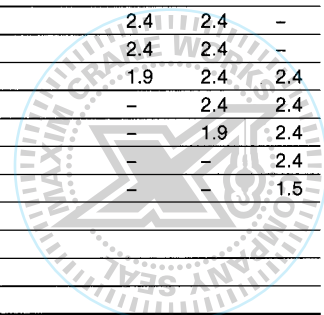

Notes to lifting capacity

Lifting capacities do not exceed 85% of tipping load.

Weight of hook blocks and slings are part of the load, and are to be deducted from the capacity ratings.

Crane operation is permissible up to a

wind speed of 32 ft/s

Consult operation manual for further details on wind speed.

All capacities above the parting line are based on structural strength. Capacities below the parting line are based on machine stability.

Crane operation is subject to computer charts, only!

For crane operations consult operation manual first!

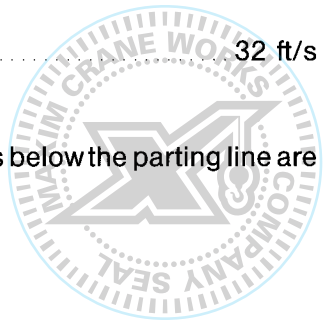

Carrier

Drive/steering

8 x 6 x 6.

Frame

Monobox main frame with outrigger boxes integral, of high-grade close-grained structural steel.

Outriggers

Four hydraulically telescoping outrigger beams with hydraulic jack legs.

Engine

Daimler-Benz OM 402 LA water-cooled 8-cylinder diesel engine. Output to DIN: 280 kW (380 HP) at 2100 rpm. Max. torque: 1775 Nm at 1200 rpm. Fuel tank capacity: 105 gallon.

Transmission

Allison automatic transmission, transfer case with off-road range.

Axles

1st: steering. 2nd: steering. 3rd: rigid, non-steering, 4th: steering. Axles 1, 2 and 4 with planetary hubs. Differential lock-out control: 2nd axle: longitudinal and transverse. 1st and 4th axle: transverse.

Suspension

Hydropneumatic suspension, all axles hydraulically blockable.

Wheels and tires

8 x 16.00 R 25 on 11.25 rims; tubeless road-tread tires. All axles single-wheeled.

Steering

Dual-circuit semiblock mechanical steering with hydraulic booster.

Brakes

Service brake: dual-line air system, acting on all wheels. Parking brake: spring-loaded type. Sustained action brake: engine exhaust brake + constant decompression and butterfly valve.

Electrical equipment

24-volt system.

Driver's cab

Rubber-mounted steel-plate 2-man cab with safety glazing and all controls, slide-by side windows, height-adjustable steering wheel, heated outside mirrors, amber beacon.

Superstructure

Hydraulic system

Driven off carrier engine at low revs, one variable-displacement axial piston pump and separate fixed-displacement pump for four simultaneous, independent working movements.

Hoist

Fixed-displacement axial-piston motor, hoist drum with planetary reduction integral and spring-loaded holding brake.

Slew unit

Hydraulic motor with planetary reduction, foot-pedal operated brake and spring-loaded holding brake.

Derricking unit

One differential cylinder with pilot-controlled lowering brake valve.

Crane cab

Spacious all-steel comfortable cab with sliding door, large fold-out window, armoured-glass roof window, controls and instrumentation for all crane movements, working light. Self-contained air heater and 7-day programmable timer, thermostat controlled. Window washer and intermittent-control wiper.

Main boom

Boom base and five telescopic sections, telescoping with partial load, fabricated from high-grade close-grained structural steel, featuring the familiar DEMAG ovaloid design.

Counterweight

17,650 t in sections of 11,250 lb, 3,750 lb and 2,650 lb (15,000 lb fitted to superstructure, 2,650 lb hydraulically stowed on carrier deck).

Safety devices

Electronic safe load indicator with digital read-out for hook load, rated load, boom length, boom angle, load radius, analog display to indicate the capacity utilization, limit switches on hoist and lowering motions, pressure-relief and safety holding valves.

Hydraulic servo control

Hydraulic pilot control through self-centering control levers.

Optional equipment

Drive

8 x 8.

Tires

Optional 16.00 R 25 on 11.25-25 rims, off-road tread, tubeless.

Hoist II

Fixed displacement axial-piston motor, hoist drum with planetary reduction integral and spring-loaded holding brake (avoids re-reeving of hoist line when using the optional jib).

Main boom extension

1- or 2-part fold-away jib, 30.2 ft or 57.7 ft, 0°, 20° and 40° offset.

Additional counterweight

22,050 lb, connects to standard counterweight, mounts hydraulically without auxiliary crane.

Heavy-lift attachment

Additional sheaves at boom head for duties over 66 US tons.

